



The Evolver 17m²

At Versatile, we understand that Kiwis value the freedom to live life on their terms. That's why we've created a smart range of affordable transportable homes designed to go where life takes you.

Built off-site and delivered fully constructed, our Versapods™ meet Healthy Home Standards and are engineered with a 50-year design life for core structural components.

With fast build times and the freedom to choose where you live, getting into your new home is easier than ever.

The Evolver is perfect as a guest house or a private retreat for independent teenagers. With enough space for a double or queen bed, it offers comfort and flexibility in a compact footprint.

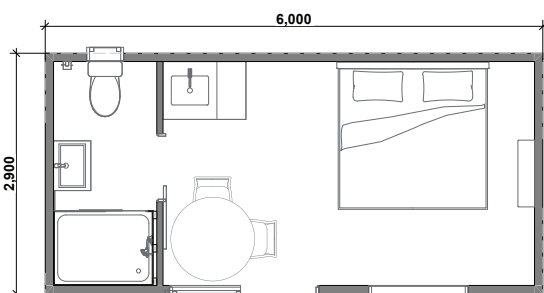

Specifications

Size: 6m x 2.9m

Cladding options:

Standard

- Ribbed EPS Panel (COLORSTEEL® FlaxPod®)

Upgraded

- Corrugate (COLORSTEEL®) Vertical or Horizontal
- Corrugate (COLORSTEEL®) + Timber

Features:

- Compliant with Healthy Homes Standards
- Bathroom with shower, toilet, vanity and basin
- Sink and storage space
- Heat pump/air conditioning
- Trickle air vents to reduce condensation and increase airflow
- Double glazed joinery
- Continuous hot water via gas califont

 **Versatile**[®]
Building Better

0800 VERSATILE [versatile.co.nz](https://www.versatile.co.nz)