



The Explorer ^{26m²}

At Versatile, we understand that Kiwis value the freedom to live life on their terms. That's why we've created a smart range of affordable transportable homes designed to go where life takes you.

Built off-site and delivered fully constructed, our Versapods™ meet Healthy Home Standards and are engineered with a 50-year design life for core structural components.

With fast build times and the freedom to choose where you live, getting into your new home is easier than ever.

The Explorer makes the most of its compact footprint (under 30m²), offering a private bedroom with space for a queen bed, a kitchen with room for a washing machine, and a separate bathroom and toilet. It's a smart solution for elderly parents, teenagers, or anyone needing independent living on your property.

Specifications

Size: 9m x 2.9m

Cladding options:

Standard

- Ribbed EPS Panel (COLORSTEEL® FlaxPod®)

Upgraded

- Corrugate (COLORSTEEL®) Vertical or Horizontal
- Corrugate (COLORSTEEL®) + Timber

Features:

- Compliant with Healthy Homes Standards
- Heat pump/air conditioning
- Double glazed joinery
- Trickle air vents to reduce condensation and increase airflow
- Bathroom with shower, toilet, vanity and basin
- Kitchen with cooktop, rangehood, sink, oven and cupboard space
- Continuous hot water via gas califont

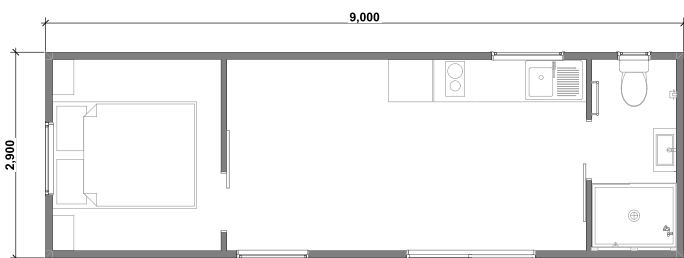

0800 VERSATILE [versatile.co.nz](https://www.versatile.co.nz)

 **Versatile®**
Building Better