



The Lifestyler 48m²

At Versatile, we understand that Kiwis value the freedom to live life on their terms. That's why we've created a smart range of affordable transportable homes designed to go where life takes you.

Built off-site and delivered fully constructed, our Versapods™ meet Healthy Home Standards and are engineered with a 50-year design life for core structural components.

With fast build times and the freedom to choose where you live, getting into your new home is easier than ever.

The Lifestyler features two bedrooms and is perfect for small families, first-home buyers, downsizers, or as a rental dwelling on your property.

Specifications

Size: 12m x 4m

Cladding options:

Standard

- Ribbed EPS Panel (COLORSTEEL® FlaxPod®)

Upgraded

- Corrugate (COLORSTEEL®) Vertical or Horizontal
- Corrugate (COLORSTEEL®) + Timber

Features:

- Compliant with Healthy Homes Standards
- Heat pump/air conditioning
- Double glazed joinery
- Trickle air vents to reduce condensation and increase air flow
- Bathroom with shower, toilet, vanity and basin
- Kitchen with cooktop, oven, rangehood, sink and cupboard space
- Two separate double bedrooms
- Hot water supplied via gas califont

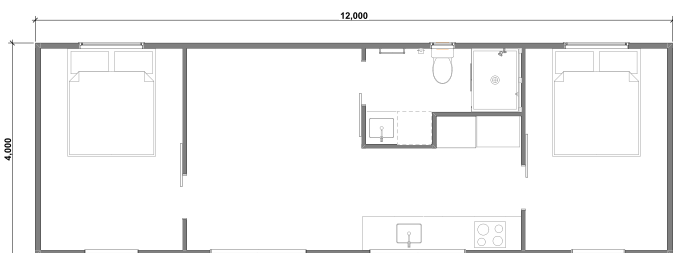

 **Versatile**[®]
Building Better

0800 VERSATILE [versatile.co.nz](https://www.versatile.co.nz)