



Image is illustrative only.  
Pictured with corrugate and timber cladding upgrade.

# The Relaxer 34m<sup>2</sup>

At Versatile, we understand that Kiwis value the freedom to live life on their terms. That's why we've created a smart range of affordable transportable homes designed to go where life takes you.

Built off-site and delivered fully constructed, our Versapods™ meet Healthy Home Standards and are engineered with a 50-year design life for core structural components.

With fast build times and the freedom to choose where you live, getting into your new home is easier than ever.

The Relaxer is an excellent choice for holiday homes, Airbnb, downsizing, or even as farmworker accommodation.

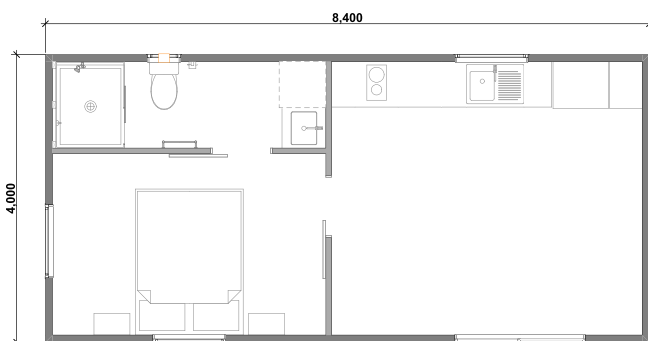

## Specifications

**Size:** 8.4m x 4m

### Cladding options:

#### Standard

- Ribbed EPS Panel (COLORSTEEL® FlaxPod®)

#### Upgraded

- Corrugate (COLORSTEEL®) Vertical or Horizontal
- Corrugate (COLORSTEEL®) + Timber

### Features:

- Compliant with Healthy Homes Standards
- Heat pump/air conditioning
- Double glazed joinery
- Trickle air vents to reduce condensation and increase airflow
- Bathroom with shower, toilet, vanity and basin
- Kitchen with cooktop, rangehood, sink, oven and cupboard space
- Separate bedroom and living space
- Hot water supplied by gas califont

 **Versatile**<sup>®</sup>  
Building Better

**0800 VERSATILE** [versatile.co.nz](https://www.versatile.co.nz)